

creu lle gwell  
creating a better place



Asiantaeth yr  
Amgylchedd Cymru  
Environment  
Agency Wales

**Licence Number EAWML 100047**

**with Introductory Note**

**Facility Type: Household, Commercial  
and Industrial Waste Transfer Station with  
Treatment**

**Environmental Protection Act 1990**

*Licence holder: South Wales Wood  
Recycling Limited  
Specified land: Locks Yard, Heol Llan, Coity  
Bridgend, Bridgend County Borough CF35  
6BU*

## Contents

INTRODUCTORY NOTE.....	2
LICENCE.....	4
CONDITIONS .....	5
1- MANAGEMENT .....	5
2- OPERATIONS.....	5
3- EMISSIONS AND MONITORING .....	6
4- INFORMATION .....	7
SCHEDULE 1- SITE PLAN.....	9
SCHEDULE 2 - OPERATIONS .....	10
SCHEDULE 3 - INTERPRETATION.....	12



DUODENIGLWYBODAETH AMRHYDDOL  
INVESTOR IN PROGRESS

---

## Introductory note

This introductory note does not form a part of the licence

This licence permits the holder to operate a Household, Commercial and Industrial Waste Transfer Station with waste treatment at the specified location. The inputs are limited to non-hazardous and inert wastes and do not include hazardous wastes such as asbestos. Wastes of similar types will be transferred into larger containers and sent to other waste facilities for further treatment, recovery or disposal. Wastes can be bulked up for disposal or recovery elsewhere and also can be treated by sorting, separation, screening, baling, shredding, crushing, chipping and compaction of waste. This licence does not permit the burning of any wastes, either in the open, inside buildings or in any form of incinerator.

This licence does not allow any emission into surface waters or groundwater. However:

- Liquids may be discharged into a sewer subject to a consent issued by the sewerage undertaker.
- Liquids may be tankered off-site for disposal or recovery.

Clean surface water from roofs, or from areas of the site that are not being used in connection with the storage and treatment of waste, may be discharged directly to surface waters, or to groundwater by percolation through the soil via a soakaway

## Operational requirements specified in regulations

Some aspects of the activity are not controlled by the conditions of this licence, because the controls are specified in the Waste Management Licensing (WML) Regulations<sup>1</sup>, or other legislation. These include:

- Regulation 4 of the WML Regulations describes the qualifications required by a technically competent person at a waste management facility.
- Section 33 (1)(c) of the Environmental Protection Act 1990 prohibits the treating, keeping or disposal of controlled waste in a manner which causes or is likely to cause pollution of the environment or harm to human health.
- Section 85 of the Water Resources Act 1991 under which it is an offence to cause or knowingly permit polluting matter to enter controlled waters (which include both surface and ground waters) unless the discharge is specifically allowed in a permit.
- The Oil Storage Regulations<sup>2</sup> require oil storage tanks to be banded.

## Public Registers

The public registers in Environment Agency offices contain information relating to licences including the application and monitoring results. Certain information may be withheld from public registers where it is commercially confidential or contrary to national security. Some information is also available on the Environment Agency's website (see below).

## Appeals against the conditions in the licence

The licence holder may appeal to the Secretary of State against any of the conditions imposed by this licence, within 6 months of the date of issue.

---

## **Licence modifications, transfers and surrender**

The Environment Agency may modify the conditions of this licence in the future. If the licence holder wishes to modify the conditions, transfer the licence to another person or surrender the licence then he must submit an application to the Environment Agency.

## **Other permits at this location**

There may be other environmental permits at this location, issued to different operators/licence holders or to the same operator/licence holder for different activities. There may also be permits issued by another regulator such as the local authority. For information on any other Environment Agency-issued permits please contact the Environment Agency (see below).

This waste management licence does not remove the licence holder or operator from their obligations under any other legislation.

## **Talking to us**

Please quote the licence number if you contact the Environment Agency about this licence.

In the event of an incident the Environment Agency may be contacted using the Incident Hotline telephone number (0800 80 70 60). Calls are free and the hotline operates 24 hours a day, 7 days a week.

For routine enquiries during office hours, the Environment Agency contact telephone number is 08708 506 506. Alternatively you can write to the Environment Agency local office (at the address given in the phone book) or go to the Environment Agency website at [www.environment-agency.gov.uk](http://www.environment-agency.gov.uk) where you can: complete an enquiry form on-line, look up the site under "what's in your backyard", or search for other information.

<sup>1</sup> - The Waste Management Licensing Regulations 1994 (SI 1994 No. 1056), (as amended).

<sup>2</sup> - The Control of Pollution (Oil Storage) (England) Regulations 2001 (SI2001 No. 2954)

*End of Introductory Note.*

## Licence

Environmental Protection Act 1990  
Waste Management Licensing  
Regulations 1994



Environment  
Agency

### Waste Management Licence Number *EAWML100047* Facility Type: Household Commercial and Industrial Waste Transfer Station with Treatment

The Environment Agency ("the Agency") in exercise of its powers under section 36 of the Environmental Protection Act 1990, hereby authorises:

***South Wales Wood Recycling Limited*** ("the licence holder"),

whose registered office (or principal place of business) is

***Old Post Office, Curwen Terrace, North Cornelly, Bridgend, Bridgend County Borough CF33 4AW***

**Company registration number 05075417**

to carry out the keeping and treatment of waste at

***Locks Yard, Heol Llan, Coity, Bridgend, Bridgend County Borough CF35 6BU***

the boundary of which is shown edged red on the site plan at schedule 1 to this licence

to the extent authorised by and subject to the conditions of this licence.

Signed

Date

	<i>31 January 2008</i>
--	------------------------

*Sean Pruce*

Authorised to sign on behalf of the Agency



# Conditions

## 1 – MANAGEMENT

### 1.1 General management

1.1.1 The activities shall be managed and operated:

- (a) in accordance with a management system, which identifies and minimises risks of pollution, including those arising from operations, maintenance, accidents, incidents and non-conformances and those drawn to the attention of the licence holder as a result of complaints; and
- (b) by sufficient persons who are competent in respect of the responsibilities to be undertaken by them in connection with the operation of the activities.

1.1.2 Records demonstrating compliance with condition 1.1.1 shall be maintained.

1.1.3 Any persons having duties that are or may be affected by the matters set out in this licence shall have convenient access to a copy of it kept at or near the place where those duties are carried out.

### 1.2 Accident management plan

1.2.1 The licence holder shall:

- (a) maintain and implement an accident management plan;
- (b) review and record at least every 4 years or as soon as practicable after an accident, (whichever is the earlier) whether changes to the plan should be made;
- (c) make any appropriate changes to the plan identified by a review.

### 1.3 Site security

1.3.1 Site security measures shall prevent unauthorised access to the site, as far as practicable.

## 2 – OPERATIONS

### 2.1 Licensed activities

2.1.1 The licence holder is authorised to carry out the activities specified in schedule 2, table 2.1 ("the activities").

### 2.2 Waste acceptance

2.2.1 Waste shall only be accepted if:

- (a) it is of a type and quantity listed in schedule 2, table 2.2; and
- (b) it conforms to the description in the documentation supplied by the producer and holder.

---

2.2.2 Records shall be maintained of all waste accepted onto the site.

## **3 – EMISSIONS AND MONITORING**

### **3.1 Emissions to air, water or land**

3.1.1 There shall be no point source emissions to air, water or land.

### **3.2 Transfers off-site**

3.2.1 Records of all the wastes sent off site from the activities, for either disposal or recovery shall be maintained.

### **3.3 Fugitive emissions of substances**

3.3.1 Fugitive emissions of substances (excluding odour and noise) shall not cause pollution. The licence holder shall not be taken to have breached this condition if appropriate measures have been taken to prevent or where that is not practicable, to minimise, those emissions.

3.3.2 Litter or mud arising from the activities shall not cause pollution. The licence holder shall not be taken to have breached this condition if appropriate measures have been taken to prevent or where that is not practicable, to minimise, the litter and mud.

3.3.3 Litter and mud arising from the activities shall be cleared from affected areas outside the site as soon as practicable.

3.3.4 All liquid wastes, whose emission to water or land could cause pollution, shall be provided with secondary containment, unless the licence holder has used other appropriate measures to prevent or where that is not practicable, to minimise, leakage and spillage from the primary container.

### **3.4 Odour**

3.4.1 Emissions from the activities shall be free from odour at levels likely to cause annoyance outside the site, as perceived by an authorised officer of the Agency, unless the licence holder has used appropriate measures to prevent or where that is not practicable, to minimise, the odour.

### **3.5 Noise**

3.5.1 Emissions from the activities shall be free from noise at levels likely to cause annoyance outside the site, as perceived by an authorised officer of the Agency, unless the licence holder has used appropriate measures to prevent or where that is not practicable, to minimise, the noise.

### **3.6 Pests**

3.6.1 Scavenging animals, scavenging birds and other pests shall not cause pollution. The licence holder shall not be taken to have breached this condition if appropriate measures have been taken to prevent or where that is not practicable, to minimise, such pollution.

---

### **3.7 Monitoring**

- 3.7.1 This licence does not require any monitoring of the activities, emissions or the environment.

## **4 – INFORMATION**

### **4.1 Records**

- 4.1.1 All records required to be made by this licence shall:
- (a) be legible;
  - (b) be made as soon as reasonably practicable;
  - (c) if amended, be amended in such a way that the original and any subsequent amendments remain legible or are capable of retrieval; and
  - (d) be retained, unless otherwise agreed by the Agency, for at least 6 years from the date when the records were made, or in the case of the following records until licence surrender:
    - (i) off-site environmental and health effects; and
    - (ii) the condition of land and groundwater.
- 4.1.2 Any records required to be made by this licence shall be supplied to the Agency within 14 days, where the records have been requested in writing by the Agency.

### **4.2 Reporting**

- 4.2.1 All reports and notifications required by the licence shall be sent to the Agency using the contact details supplied in writing by the Agency.
- 4.2.2 A summary report of the waste types and quantities accepted and removed from the site shall be made for each quarter. It shall be submitted to the Agency within one month of the end of the quarter and shall be in the format required by the Agency.

### **4.3 Notifications**

- 4.3.1 The Agency shall be notified without delay following the detection of:
- (a) any malfunction, breakdown or failure of equipment or techniques, accident or fugitive emission which has caused, is causing or may cause significant pollution;
  - (b) the breach of a limit specified in this licence; and
  - (c) any significant adverse environmental and health effects.
- 4.3.2 Written confirmation of actual or potential pollution incidents and breaches of emission limits shall be submitted within 24 hours.
- 4.3.3 Prior written notification shall be given to the Agency of the following events and in the specified timescales:
- (a) as soon as practicable prior to the permanent cessation of any of the activities;
  - (b) cessation of operation of all or part of the activities for a period likely to exceed 3 months;
  - (c) resumption of the operation of all or part of the activities after a cessation notified under (b) above

- 
- 4.3.4 Where the Agency has requested in writing that it shall be notified when the licence holder is to undertake monitoring and/or spot sampling, the licence holder shall inform the Agency when the relevant monitoring is to take place. The licence holder shall provide this information to the Agency at least 14 days before the date the monitoring is to be undertaken.
- 4.3.5 The Agency shall be notified within 7 days of any changes in technically competent management and the name of any incoming person together with evidence that such person has the required technical competence.
- 4.3.6 The Agency shall be notified within 14 days of the licence holder and/or any relevant person being convicted of a relevant offence, (unless such information has already been notified to the Agency), with details of the nature of the offence, the place and date of conviction, and the sentence imposed.
- 4.3.7 The Agency shall be notified within 14 days of the licence holder and/or any relevant person lodging an appeal against a conviction for any relevant offence and of the outcome when the appeal is decided.
- 4.3.8 The Agency shall be notified within 14 days of the occurrence of the following matters except where such disclosure is prohibited by Stock Exchange rules:
- a) Where the licence holder is a registered company:
    - any change in the licence holder's trading name, registered name or registered office address
    - any change to particulars of the licence holder's ultimate holding company (including details of an ultimate holding company where a licence holder has become a subsidiary);
    - any steps taken with a view to the licence holder going into administration, entering into a company voluntary arrangement or being wound up; and
    - if the licence holder is not the operator: any change in the operators trading name; address; registered name or registered office address.
  - b) Where the licence holder is a corporate body other than a registered company:
    - any change in the licence holder's name or address;
    - any steps taken with a view to the dissolution of the licence holder; and
    - if the licence holder is not the operator: any change in the operators trading name; address; registered name or registered office address.
  - c) In any other case:
    - the death of any of the named licence holders (where the licence holder consists of more than one named individual);
    - any steps taken with a view to the licence holder, or any one of them, going into bankruptcy, entering into a composition or arrangement with creditors, or, in the case them being in a partnership, dissolving the partnership; and
    - if the licence holder is not the operator: any change in the operators trading name; address; registered name or registered office address.
- 4.3.9 The Agency shall be notified at least 7 days in advance of the commencement of any of the activities.

## 4.4 Interpretation

- 4.4.1 In this licence the expressions listed in schedule 3 shall have the meaning given in that schedule.



# Schedule 1- Site plan

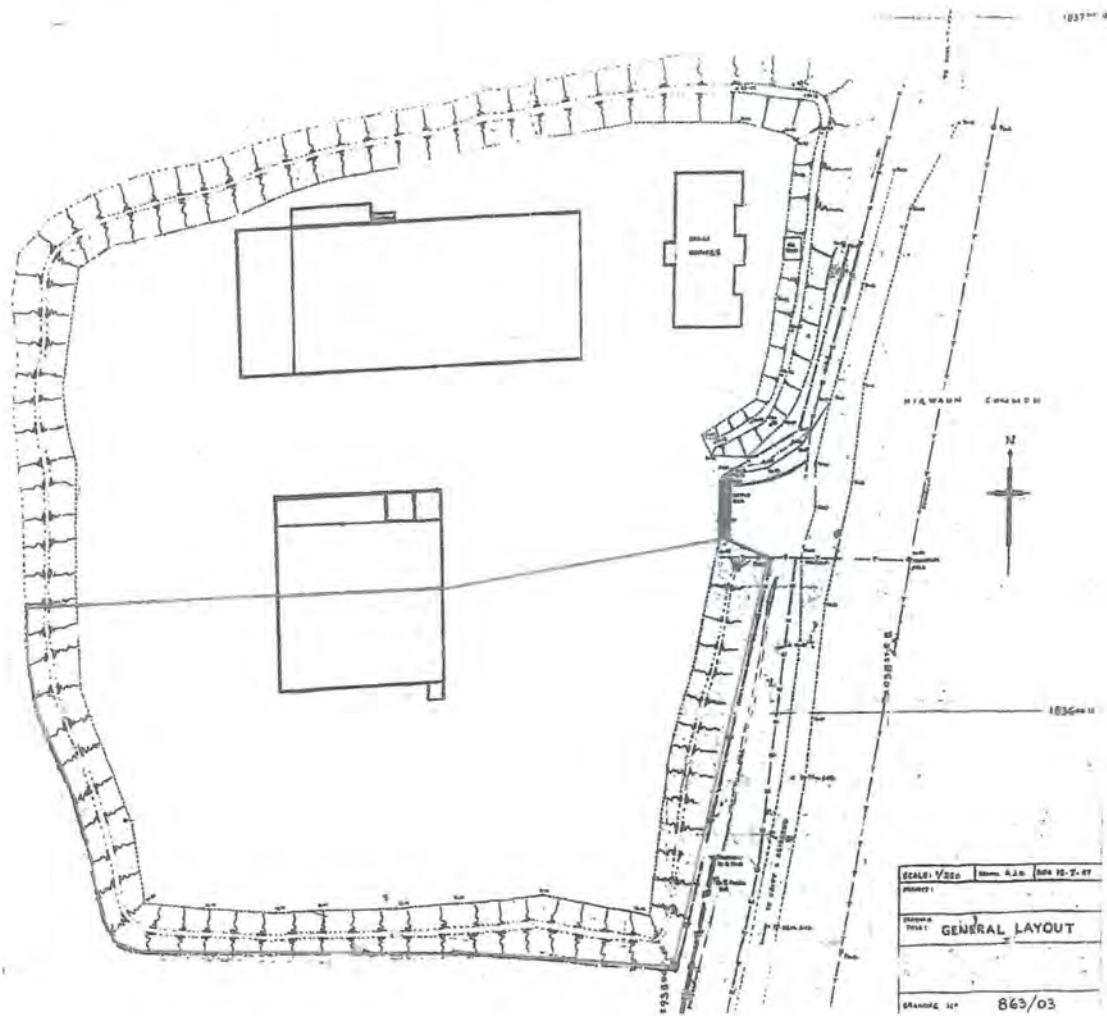

"Reproduced from the Ordnance Survey map with the permission of the Controller of Her Majesty's Stationery Office ©Crown Copyright 2000. Unauthorised reproduction infringes Crown Copyright and may lead to prosecution or civil proceedings."

## Schedule 2 - Operations

Table 2.1 Licensed activities	
Description of activities	Limits of activities
<p><b>D15:</b> Storage of waste pending any of the operations listed in paragraphs 1 to 14 of this Part of this Schedule, but excluding temporary storage, pending collection, on the site where the waste is produced.</p> <p><b>R13:</b> Storage of waste pending any of the operations listed in paragraphs 1 to 12 of this Part of this Schedule, but excluding temporary storage, pending collection, on the site where it is produced.</p> <p><b>D14:</b> Repackaging of waste prior to the waste being submitted to any of the operations listed in paragraphs 1 to 13 of this Part of this Schedule.</p>	<p>Non-hazardous wood waste must be kept on an impermeable surface with sealed drainage.</p>
<p><b>D9:</b> Physico-chemical treatment of waste not listed elsewhere in this Part of this Schedule which results in final compounds or mixtures which are discarded by means of any of the operations listed in paragraphs 1 to 12 of this Part of this Schedule (for example, evaporation, drying, calcination).</p> <p><b>R3:</b> Recycling or reclamation of organic substances which are not used as solvents, including composting and other biological transformation processes.</p> <p><b>R4:</b> Recycling or reclamation of metals and metal compounds</p> <p><b>R5:</b> Recycling or reclamation of other inorganic materials</p>	<p>Treatment consisting only of manual sorting, separation, screening, shredding or chipping of non-hazardous wood waste into different components for disposal, (no more than 50 tonnes per day) or recovery.</p> <p>Treatment of non-hazardous wood waste must be carried out on an impermeable surface with sealed drainage.</p>

Table 2.2 Licensed waste types and quantities	
<p><b>Maximum Quantities</b></p> <p>The quantity of wastes listed below, accepted at the site shall be less than 25,000 tonnes a year.</p>	
<p><b>Exclusions</b></p> <p>Notwithstanding the specification of waste types below, wastes shall not be accepted at the site which have any of the following characteristics:</p> <ul style="list-style-type: none"> <li>• Consisting solely or mainly of dusts, powders or loose fibres</li> <li>• Wastes that are in a form which is either sludge or liquid</li> </ul>	
Waste Code	Description
03	WASTES FROM WOOD PROCESSING AND THE PRODUCTION OF PANELS AND FURNITURE, PULP, PAPER AND CARDBOARD
03 01	wastes from wood processing and the production of panels and furniture
03 01 01	waste bark and cork
03 01 05	sawdust, shavings, cuttings, wood, particle board and veneer other than those mentioned in 03 01 04

03 03	wastes from pulp, paper and cardboard production and processing
03 03 01	waste bark and wood
15	WASTE PACKAGING: ABSORBENTS, WIPING CLOTHS, FILTER MATERIALS AND PROTECTIVE CLOTHING NOT OTHERWISE SPECIFIED
15 01	packaging (including separately collected municipal packaging waste)
15 01 03	wooden packaging
17	CONSTRUCTION AND DEMOLITION WASTES (INCLUDING EXCAVATED SOIL FROM CONTAMINATED SITES)
17 02	wood, glass and plastic
17 02 01	wood
20	MUNICIPAL WASTES (HOUSEHOLD WASTE AND SIMILAR COMMERCIAL, INDUSTRIAL AND INSTITUTIONAL WASTES) INCLUDING SEPARATELY COLLECTED FRACTIONS
20 01	separately collected fractions (except 15 01)
20 01 38	wood other than that mentioned in.20 01.37

---

## Schedule 3 – Interpretation

"*accident*" means an accident that may result in pollution.

"*authorised officer*" means any person authorised by the Agency under section 108(1) of The Environment Act 1995 to exercise, in accordance with the terms of any such authorisation, any power specified in Section 108(4) of that Act.

"*building*" means a construction that has the objective of providing sheltering cover and minimising emissions of noise, particulate matter, odour and litter.

"*emissions to land*", include emissions to groundwater.

"*fugitive emission*" means an emission to air, water or land from the activities which is not controlled by an emission limit.

"*groundwater*" means all water, which is below the surface of the ground in the saturation zone and in direct contact with the ground or subsoil.

"*impermeable surface*" means a surface or pavement constructed and maintained to a standard sufficient to prevent the transmission of liquids beyond the pavement surface, and should be read in conjunction with the term "sealed drainage system" (below).

"*notify/notified without delay*" means that a telephone call can be used, whereas all other reports and notifications must be supplied in writing, either electronically or on paper.

"*pollution*" includes pollution of the environment, harm to human health and serious detriment to the amenities of the locality, resulting from the licensed activities.

"*quarter*" means a calendar year quarter commencing on 1 January, 1 April, 1 July or 1 October.

"*relevant person*" and "*relevant offence*" shall have the meaning given to them in the Environmental Protection Act 1990

"*sealed drainage system*" in relation to an impermeable surface, means a drainage system with impermeable components which does not leak and which will ensure that:

- (a) no liquid will run off the surface otherwise than via the system;
- (b) except where they may lawfully be discharged, all liquids entering the system are collected in a sealed sump.

"*sewer*" means sewer within the meaning of section 219(1) of the Water Industry Act 1991.

"*technically competent management*" and "*technical competence*" shall be as prescribed under Section 74 of the Environmental Protection Act 1990.

"*waste code*" means the code specified in The List of Wastes (England) Regulations 2005 (SI 2005 No. 895) as amended, or The List of Wastes (Wales) Regulations 2005 (SI 2005 No.1820) (W.148) as amended. Codes marked with an \* are hazardous waste, as defined in those regulations. Licence conditions apply to those wastes listed with a six-digit code.

"*Waste Management Licensing Regulations*", means The Waste Management Licensing Regulations 1994 (SI1994 No. 1056) (as amended).

"*year*" means calendar year commencing on 1<sup>st</sup> January.